

Lanza Professional Aquifier Water Filter Tap

abode

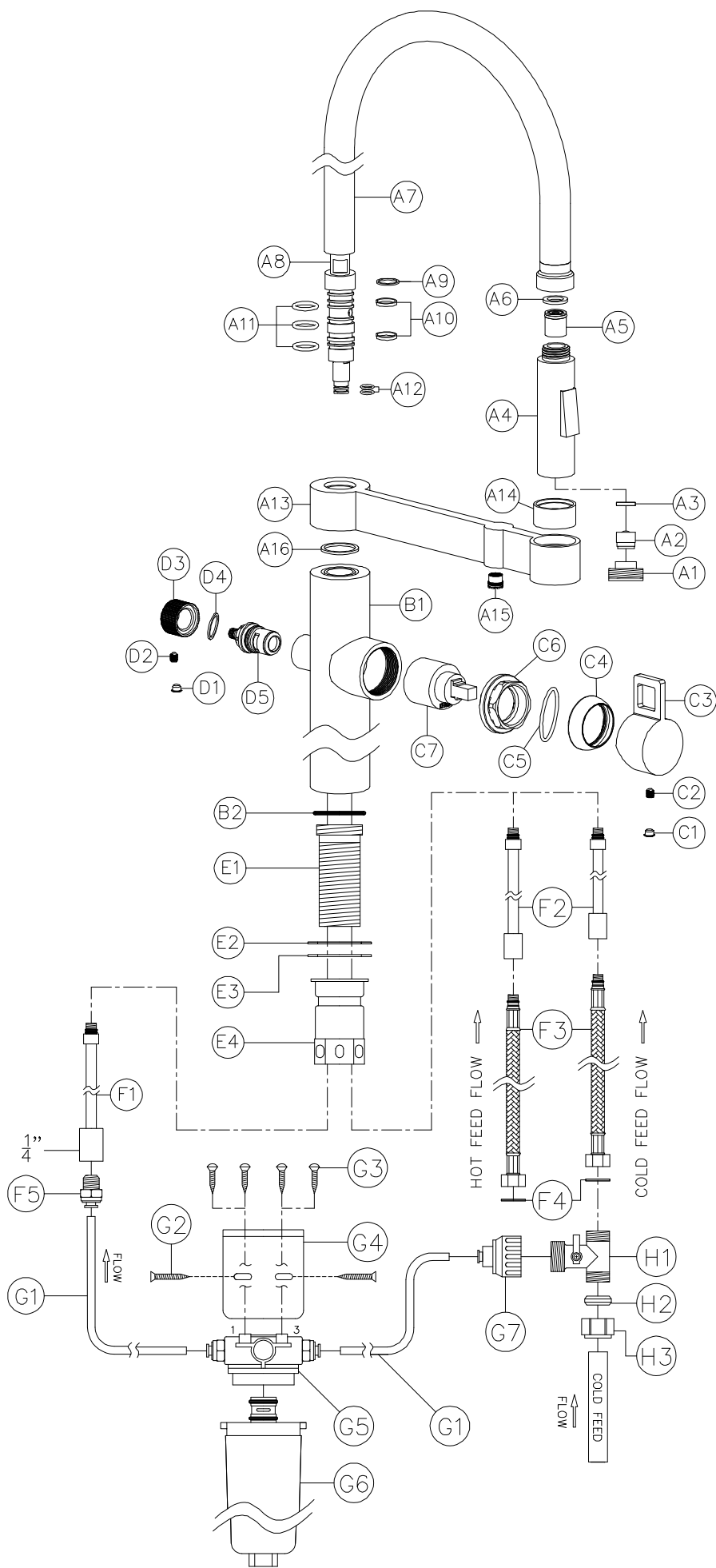

General Advice:

- These instructions are intended as a guide only, if you are in any doubt you should seek the advice of a qualified professional.
- Take care not to mark finished parts with screwdrivers or other tools.
- Use a pair of rubber gloves to get a better grip on decorative hand tight parts.
- Ensure all parts are reassembled tightly.
- After maintenance test that all assemblies are water tight and function correctly.
- Always isolate the hot and cold water supplies before starting any maintenance, once isolated you should drain any residual water from your system.

To replace the single lever valve:

1. Remove dust cap (C1) vertically away from handle (C3).
2. Loosen grub screw (D2) on the underside of handle (C3) using a 2.5mm A/F allen key.
3. Pull the handle (C3) horizontally away from the tap body (B1).
4. Pull the decorative cover (C4) horizontally away from tap body (B1) by hand. Note seal (C5) is pre-inserted.
5. With the tap (B1) fixed to the sink/base unit, using an adjustable spanner unscrew the valve lock nut (C6).
6. Clean the Inside of chamber (B1) with a soft wet cloth.
7. Replace the faulty valve (C7) with the new one and assemble in reverse order.

To replace the filter valve:

1. Remove dust cap (D1) vertically away from handle (D3).
2. Loosen grub screw (D2) on the underside of handle (D3) using a 2.0mm A/F allen key.
3. Pull the handle (D3) horizontally away from the tap body (B1).
4. With the tap (B1) fixed to the sink/base unit, using an adjustable spanner unscrew the valve (D5).
5. Clean the Inside of chamber (B1) with a soft wet cloth.
6. Replace the faulty valve (D5) with the new one and assemble in reverse order.

To replace the spout o-rings:

1. Pull the rubber hose (A7) vertically so that the flat spanner section of spout part (A8) is revealed.
2. With the tap (B1) fixed to the sink/base unit, using an adjustable spanner unscrew the spout part (A8) and pull vertically away from spout bracket (A13) & tap body (B1).
3. Remove upper PTFE rings (A9 & A10) and O-rings (A11 & A12) using a precision screwdriver and replace with new ones.
4. Reassemble the tap in reverse order.